

Ttl. No.	Part No.	Description	Qty. Rqd.
----------	----------	-------------	-----------

INSTRUMENTS AND SWITCHES

REMARKS LEGEND -

Vehicle i.d. (v) numbers:

SA = 1995 model year;

TA = 1996 model year ;

VA = 1997 model year



1
SPEEDOMETER
#STC1312G

Instruments

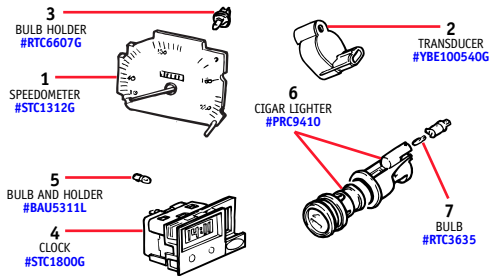

1	STC1312G	SPEEDOMETER, MPH, Genuine <i>Through 1995 model year</i>	1
2	YBE100540G	TRANSDUCER, speed, Genuine <i>Fitted to transfer box</i>	1
3	RTC6607G	BULB HOLDER, instruments, 1.12W, black body, Genuine	A/R
4	STC1800G	CLOCK ASSEMBLY, Genuine <i>Does not include hazard light switch</i>	1
5	BAU5311L	BULB HOLDER AND BULB, clock	1
6	PRC9410	CIGAR LIGHTER ASSEMBLY	2
7	RTC3635	BULB, 1.2W, cigar lighter	2

PRICES SUBJECT TO CHANGE.
Call for the Latest Pricing and Availability.

Ttl. No.	Part No.	Description	Qty. Rqd.
----------	----------	-------------	-----------

Fascia Switches

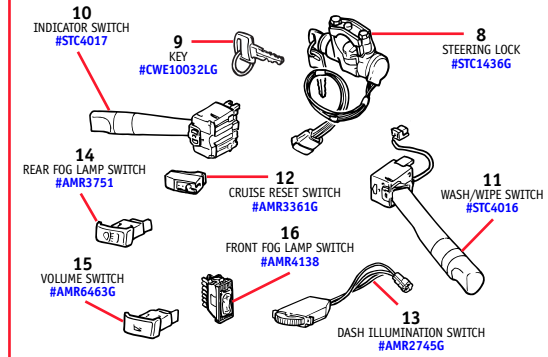

8	STC1436G	LOCK ASSY, steering, with ignition switch <i>Genuine, Automatic transmission</i>	1
	STC1435	IGNITION SWITCH/LOCK, D1 Manual Trans	1
	STC1746	IGNITION SWITCH, Electrical Part D1	1
9	CWE10032LG	KEY, blank, Genuine	A/R
		<i>Original style with rubber head</i>	
10	STC4017	SWITCH, turn indicator and headlamps	1
11	STC4016	SWITCH, wash/wipe, front	1
12	AMR3361G	SWITCH, cruise control, reset/cancel, Genuine	1
13	AMR2745G	SWITCH, rheostat, dash illumination, Genuine	1
14	AMR3751	SWITCH, rear fog lamp <i>Through (v) TA534103 and TA703236</i>	1
15	AMR6463G	SWITCH, volume control, down, Genuine <i>From (v) VA543814 and VA712445 on; can be fitted to earlier models</i>	1
16	AMR4138	SWITCH, front fog lamp, Genuine <i>From 1996 model year on</i>	1

Window and Seat Switches

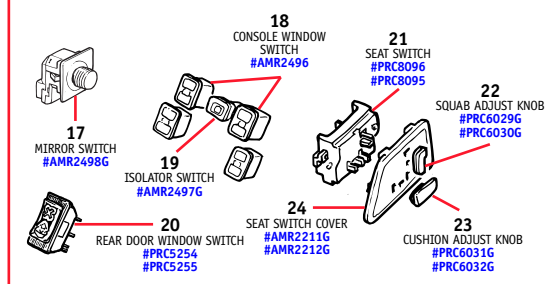

17	AMR2498G	SWITCH, door mirror, Genuine <i>Up to (v) VA745654</i>	1
18	AMR2496	SWITCH, window lift, console	4
19	AMR2497G	SWITCH, isolator, window lift, Genuine	1
20	PRC5254	SWITCH, window lift, rear door, RH	1
	PRC5255	SWITCH, window lift, rear door, LH	1
21	PRC8096	SWITCH ASSY, seat, non-memory, LH	1
	PRC8095	SWITCH ASSY, seat, non-memory, RH	1
22	PRC6029G	KNOB, switch, squab adjust, LH, Genuine	1
	PRC6030G	KNOB, switch, squab adjust, RH, Genuine	1
23	PRC6031G	KNOB, switch, cushion adjust, LH, Genuine	1
	PRC6032G	KNOB, switch, cushion adjust, RH, Genuine	1

Ttl. No.	Part No.	Description	Qty. Rqd.
----------	----------	-------------	-----------

24	AWR2211G	COVER, seat switch, LH, Genuine	1
	AWR2212G	COVER, seat switch, RH, Genuine	1

Sunroof and Courtesy Lamp Switches

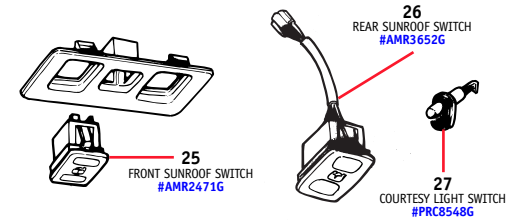

25	AMR2471G	SWITCH, sunroof, front, Genuine	1
26	AMR3652G	SWITCH, sunroof, rear, Genuine	1
27	PRC8548G	SWITCH, door, courtesy lamp, Genuine	5

TECH TIP:

Discovery Clock Replacement



If your clock unit has failed, it is easily replaced with part #STC1800G (see 4), however, removing the old unit requires some specific steps as follows:

- Remove drinks tray
 - Remove ashtray by pushing spring clip down. Remove auxiliary switch panel, it snaps out.
 - Remove six screws holding tray. Three in each compartment where switch panel and ashtray were.
- Remove clock by releasing four tabs that hold the clock in place
 - To release the tabs, insert a thin strip of metal such as a feeler gauge at four places indicated in picture. **You will need to do all four at the same time.**
 - Slide clock out and disconnect electrical plugs.
 - Install new unit by connecting electrical plugs and snap back in place
 - Install drinks tray, ashtray and switch panel.

